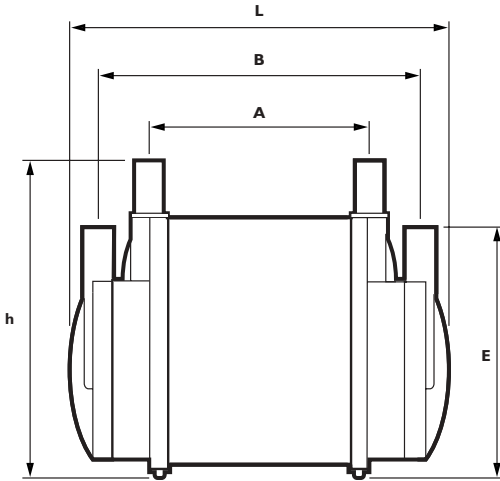

**QT80 shower pump 2.3 bar twin**

- A.** 175mm  
**B.** 300mm  
**E.** 180mm  
**h.** 220mm  
**L.** 340mm  
**Width** 130mm

**Data**

Max Inlet Pressure	– 1.5 Bar
Max Inlet hot Temperature	– 70°C
Voltage	– 220/240V
Watts	– 490W
Fuse Rating	– 5A
Speed	– 2800 RPM
Insulation Class	– F
Rating	– Intermittent 30 Min on/off

**Connection**

“Push on” flexible hose	– 22mm
-------------------------	--------

**Materials**

Body	– Glass filled noryl
Casing	– Glass filled noryl
Shaft	– Stainless steel
Seals	– Carbon/silicon carbide
CE Approval	

**Code numbers**

QT80 shower pump-twin ended-intermittently rated  
 Code no. QT8000

**Application**

The QT80 twin ended pump is designed to pump hot and cold water simultaneously and to boost flow and pressure to shower systems, and other terminal applications. The pump is supplied with 22mm “Push On” type connections and will deliver 20 L/Min at 1.8 bar. QT80 is intermittently rate (30 min on/30 min off). Where prolonged pumping is required, then the Douglas Turbo 4 single or twin end pumps should be fitted.

**How to specify**

Douglas QT80 shower pump 2.3 bar twin ended intermittently rated 220/240V. Code no. QT8000

